

Exploded view - centre console (convenience equipment version)

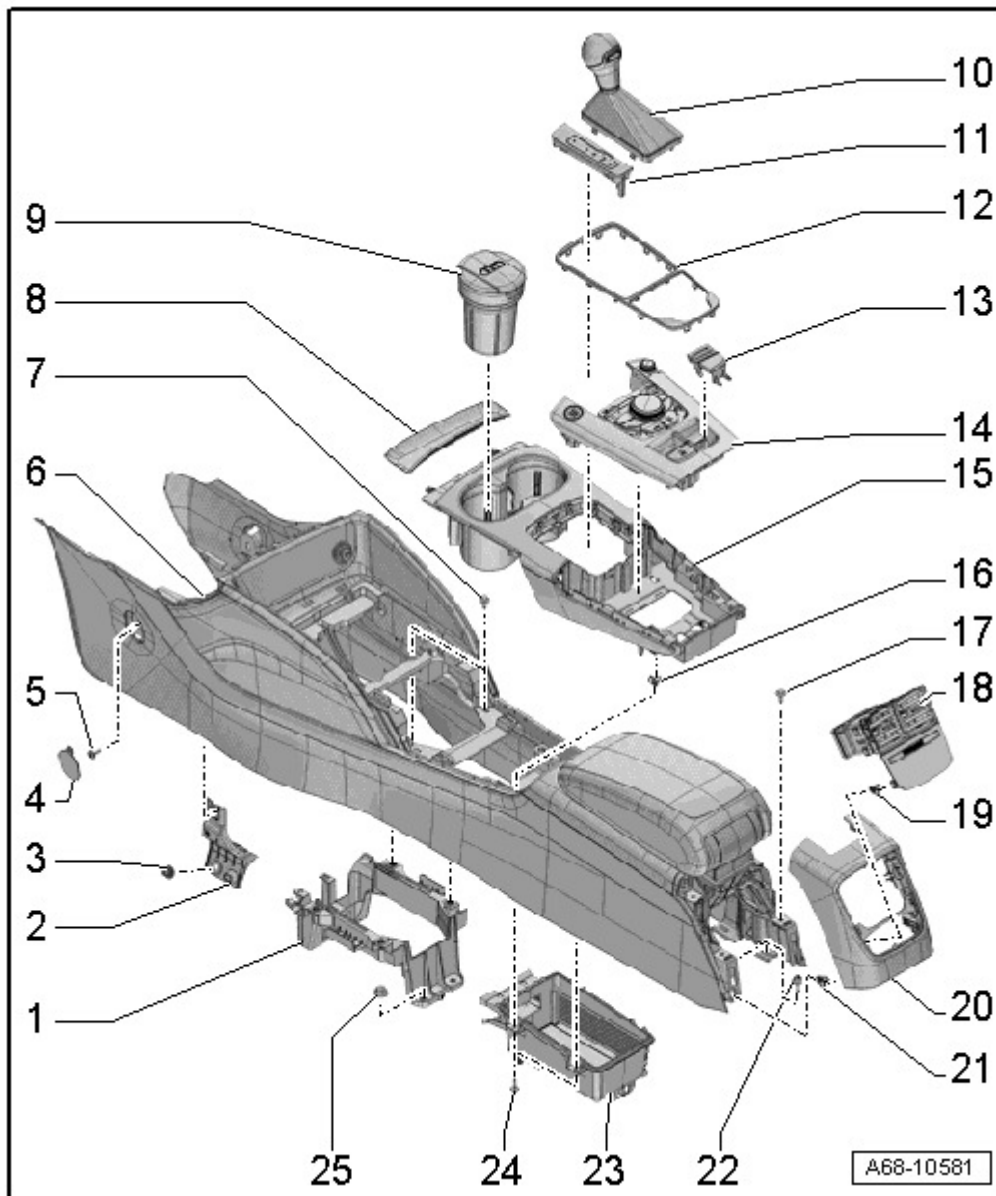

1 - Mounting bracket

q For centre console

q Removing and installing → [Chapter „Removing and installing bracket for centre console“](#)

2 - Bracket (front)

q For centre console

q 2x

q Removing and installing → [Chapter „Removing and installing bracket for centre console“](#)

3 - Nut

q 2x

q 3.5 Nm

4 - Cap

q 2x

q Press into centre console

5 - Bolt

q 2x

q 1.5 Nm

6 - Centre console

q Removing and installing → [Chapter](#)q Equipment version with storage net: Fitting storage net in new centre console → [Chapter](#)

7 - Bolts

q 4x

q 3 Nm

8 - Lining mat

9 - Ashtray

q Depending on equipment version

q Audi logo on ashtray lid is perpendicular to direction of travel; ashtray can be used from driver's position

10 - Gear lever/selector lever

q Exploded view → [Rep. gr.34](#)

11 - Selector lever position display -Y26-

q Overview of fitting locations → [Electrical system; Rep. gr.96](#)

12 - Trim panel

q For insert for centre console

q Removing and installing → [Chapter](#)

13 - Coin holder

q For correct version refer to → [Electronic parts catalogue](#)q Removing and installing → [Chapter](#)

q Engage in rear of centre console and press on until it engages audibly

14 - Multimedia system operating unit -E380-

q For correct version refer to → [Electronic parts catalogue](#)q Overview of fitting locations → [Communication; Rep. gr.91](#)

q Press on until it engages audibly

15 - Insert for centre console

q Removing and installing → [Chapter](#)

q Renew clips if damaged or deformed

q Engage in front of centre console and press on until it engages audibly

16 - Clip

q For insert for centre console

q 6x

q Renew clips if damaged or deformed

q Fit in insert

17 - Bolt

q 4x

- q 3 Nm
- 18 - Storage compartment/vent
 - q Removing and installing → [Chapter](#)
 - q Making opening for cigarette lighter/socket in new storage compartment → [Chapter](#)
 - q Renew clips if damaged or deformed
 - q Insert in installation position and press in as far as stop
- 19 - Clip
 - q For storage compartment
 - q 6x
 - q Renew clips if damaged or deformed
 - q Insert in storage compartment
- 20 - Cover (rear)
 - q For centre console
 - q For correct version refer to → [Electronic parts catalogue](#)
 - q Removing and installing → [Chapter](#)
 - q Press on until it engages audibly
- 21 - Clip
 - q For cover
 - q 4x
 - q Renew clips if damaged or deformed
 - q Insert in cover
- 22 - Bolt
 - q 4x
 - q Tightening torque → [Chapter](#)
- 23 - Storage box
 - q For correct version refer to → [Electronic parts catalogue](#)
 - q Removing and installing → [Chapter](#)
- 24 - Bolt
 - q 4x
 - q 1.4 Nm
- 25 - Nut
 - q 4x
 - q 8 Nm