

Removing and installing luggage compartment side trim panel



Note

Removal and installation are described for the left vehicle side. Follow same instructions for the right side as appropriate.

Removing

- Removing lock carrier cover → Chapter.
- Remove bench seat → Chapter.
- Remove backrest → Chapter.
- Models with 4-doors, remove wheel housing trim → Chapter.
- Models with 2-doors, release sill moulding from fasteners in sill at transition to side panel and remove side panel trim → Chapter.
- Removing side support for luggage compartment cover → Chapter.
- If fitted, remove mounting parts for variable luggage compartment floor → Chapter.
- Release trim -1- inwards out of mountings.

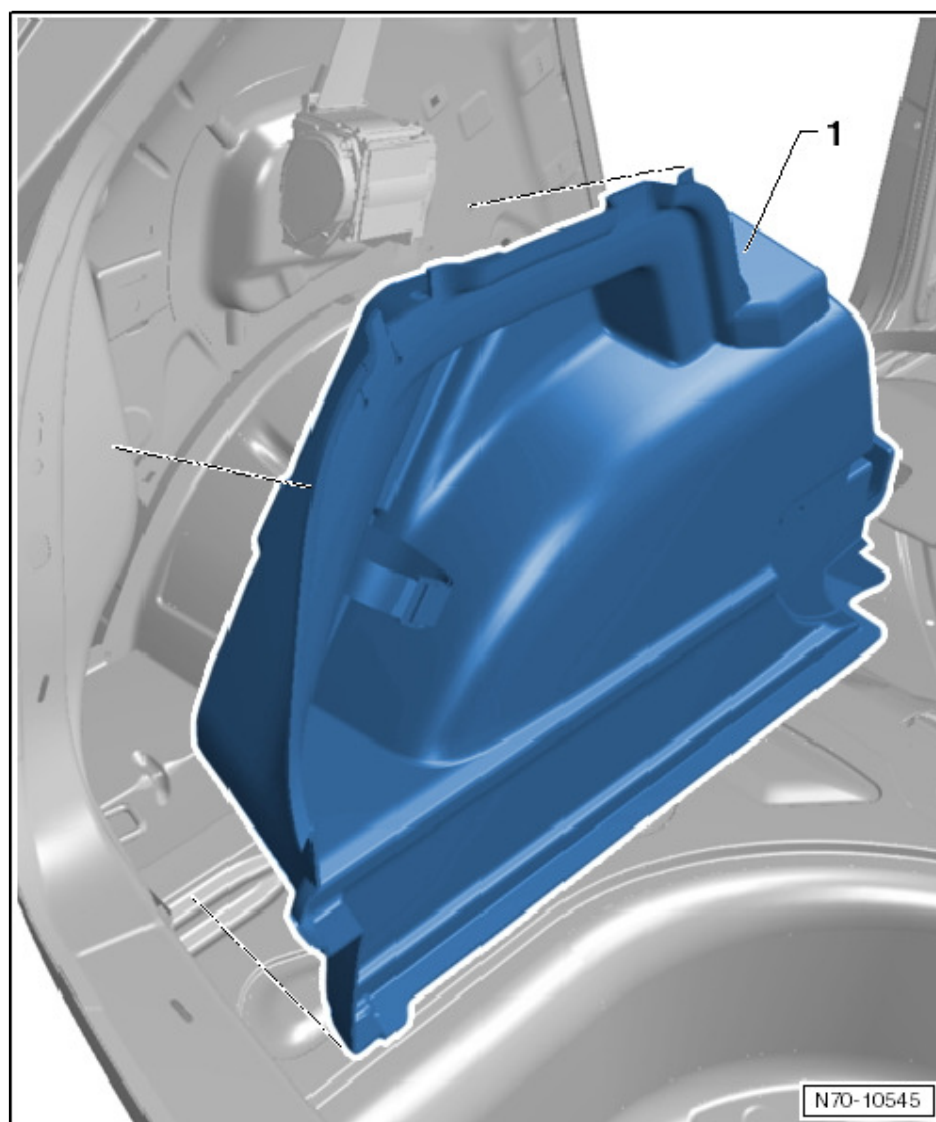

Installing

- Install in reverse order of removal.